

TECHNICAL DATASHEETS

KERKA Side interlocking clay plain tiles

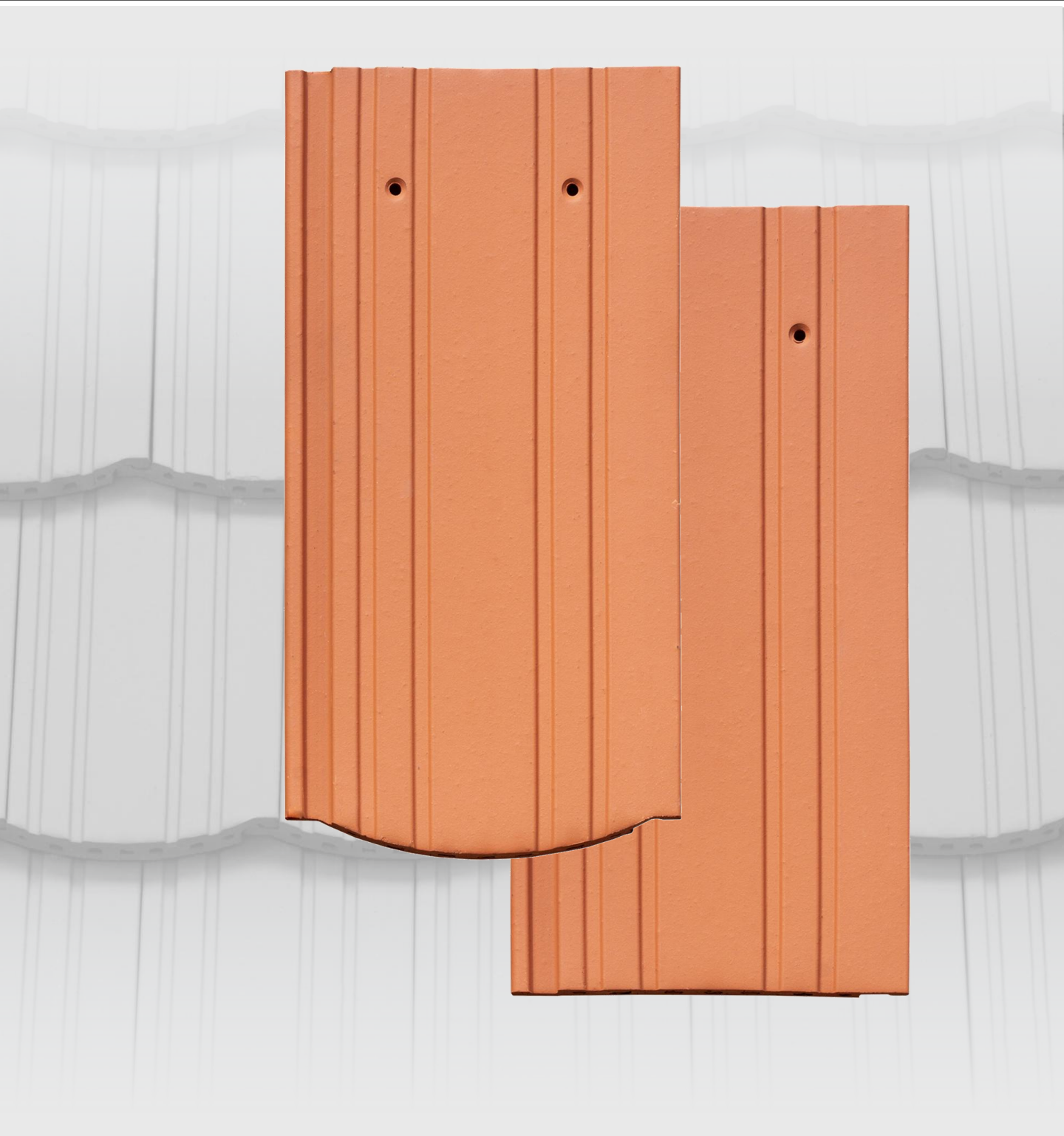

CREATON South-East Europe Kft.**Technical department****H-8960 Lenti, Cserépgyár utca 1.**

The informations provided in this documents, are textual guidelines, the datas in the form of technical drawings correspond to the current technical knowledge at the time of publication and based to the experience of CREATON South-East Europe Kft.. This application guide contains only a part of the product informations. The described applications, examples, do not take into account the special features that may arise in individual cases.

All datas and the suitability of the material for the intended use must always be checked on the construction site! CREATON South-East Europe Kft. disclaims all warranties related the provided informations. This includes typographical errors and the subsequent changes to the specifications.

“KERKA”[®] segmented cut

Product datas		Covering method
Size	width:	205 mm
	length:	400 mm
	height:	35 mm
	thickness:	21 mm
Packaging	Weight:	2,42 kg
	bundle:	6 pcs
	pallet:	324 pcs
Standard roof pitch :		30°

In binding

Technical specification of the roof cover					
Roof pitch:	< 30°	30° - 35°	35° - 40°	40° - 45°	45° <
Covering length	265 mm	274 mm	285 mm	295 mm	305 mm
Covering width	180 mm	180 mm	180 mm	180 mm	180 mm
Consumption	21,0 pcs/m ²	20,2 pcs/m ²	19,5 pcs/m ²	18,8 pcs/m ²	18,2 pcs/m ²
Covering type	single cover				
Covering weight	50,82 kg/m ²	48,89 kg/m ²	47,19 kg/m ²	45,50 kg/m ²	44,05 kg/m ²

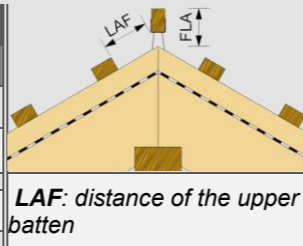

LAF: distance of the upper batten

FLA: height of the ridge batten

BZ ridge tile with 30x50 roof batten											
Roof pitch	10°	15°	20°	25°	30°	35°	40°	45°	50°	55°	60°
LAF [mm]	55	55	55	55	55	55	50	50	50	50	50

Underlayment requirement		
Unsupported underlayment	“UNO”	≥ 24°
Windproof underlayment	“DUO”	≥ 22°
Watertight underlayment	“TRIO”	≥ 18°
Waterproof underlayment	“QUATTRO”	≥ 10°

Required batten dimensions	
Rafter distance	Batten dimension
≤ 800 mm	30 x 50 mm
810 – 900 mm	30 x 50 mm
910 – 1000 mm	40 x 60 mm

“BZ” ridge tile 3,0 db/fm	Closing plate	Hip cap 3 axle
	Hip starter	Hip cap 4 axle

Clay accessories	Size	Quantity
Half tile	115x400	as needed
RÓNA ventilation tile LQ 25	205x400	as required

Fixing products		
Name	Material	Application field
Mount-on stormclip for 30x50 mm battens	zinc-aluminium	Fixing against the wind in the edge zones and some cases in the general roof surface
Mount-on stormclip for 40x60 mm battens	zinc-aluminium	
Nail-in stormclip	stainless steel, CELANEX [®] PBT	Leesés elleni rögzítés szegélyek mentén és bizonyos esetekben általános tetőfelületeken.
Fixing screw with EPDM sealing ring, 60 mm length	stainless steel	
Clip with wire, 17-21 mm	stainless steel	Fixing against loosed tiles along the edges and some cases in the average roof surfaces
Universal screw-in stormclip	zinc-aluminium	Fixing cutted tiles along the hips and valleys

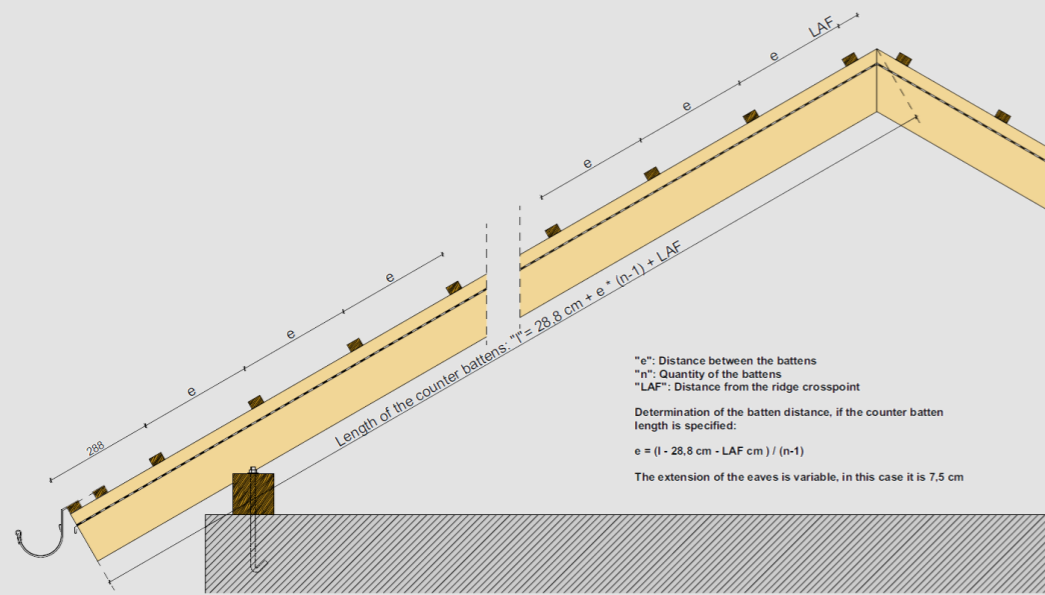

Roof batten alignment for "KERKA" segment cut clay roof tile					
Specification:	7,5 cm eave overhang and 30° roof pitch "BZ" ridge tile and 30x50 mm roof battens, LAF = 55 mm				
Number of battens (n)	265 mm	274 mm	285 mm	295 mm	305 mm
10	2 728	2 809	2 908	2 998	3 088
11	2 993	3 083	3 193	3 293	3 393
12	3 258	3 357	3 478	3 588	3 698
13	3 523	3 631	3 763	3 883	4 003
14	3 788	3 905	4 048	4 178	4 308
15	4 053	4 179	4 333	4 473	4 613
16	4 318	4 453	4 618	4 768	4 918
17	4 583	4 727	4 903	5 063	5 223
18	4 848	5 001	5 188	5 358	5 528
19	5 113	5 275	5 473	5 653	5 833
20	5 378	5 549	5 758	5 948	6 138
21	5 643	5 823	6 043	6 243	6 443
22	5 908	6 097	6 328	6 538	6 748
23	6 173	6 371	6 613	6 833	7 053
24	6 438	6 645	6 898	7 128	7 358
25	6 703	6 919	7 183	7 423	7 663
26	6 968	7 193	7 468	7 718	7 968
27	7 233	7 467	7 753	8 013	8 273
28	7 498	7 741	8 038	8 308	8 578
29	7 763	8 015	8 323	8 603	8 883
30	8 028	8 289	8 608	8 898	9 188
31	8 293	8 563	8 893	9 193	9 493
32	8 558	8 837	9 178	9 488	9 798
33	8 823	9 111	9 463	9 783	10 103
34	9 088	9 385	9 748	10 078	10 408
35	9 353	9 659	10 033	10 373	10 713
36	9 618	9 933	10 318	10 668	11 018
37	9 883	10 207	10 603	10 963	11 323
38	10 148	10 481	10 888	11 258	11 628
39	10 413	10 755	11 173	11 553	11 933
40	10 678	11 029	11 458	11 848	12 238

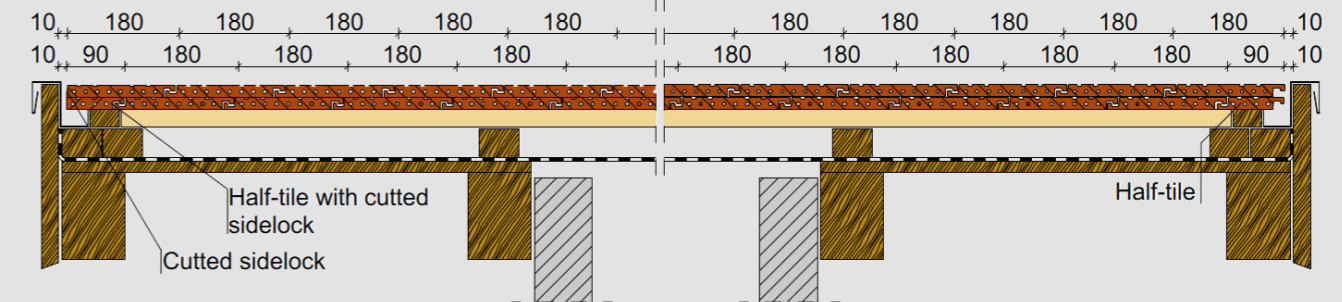

Structural width between the verge boards										
	0	1/2	1	1 1/2	2	2 1/2	3	3 1/2	4	4 1/2
0	-	90	180	270	295	385	475	565	655	745
10	1 735	1 825	1 915	2 005	2 095	2 185	2 275	2 365	2 455	2 545
20	3 535	3 625	3 715	3 805	3 895	3 985	4 075	4 165	4 255	4 345
30	5 335	5 425	5 515	5 605	5 695	5 785	5 875	5 965	6 055	6 145
40	7 135	7 225	7 315	7 405	7 495	7 585	7 675	7 765	7 855	7 945
50	8 935	9 025	9 115	9 205	9 295	9 385	9 475	9 565	9 655	9 745
60	10 735	10 825	10 915	11 005	11 095	11 185	11 275	11 365	11 455	11 545
70	12 535	12 625	12 715	12 805	12 895	12 985	13 075	13 165	13 255	13 345
80	14 335	14 425	14 515	14 605	14 695	14 785	14 875	14 965	15 055	15 145
90	16 135	16 225	16 315	16 405	16 495	16 585	16 675	16 765	16 855	16 945
100	17 935	18 025	18 115	18 205	18 295	18 385	18 475	18 565	18 655	18 745

Structural width between the verge boards										
	5	5 1/2	6	6 1/2	7	7 1/2	8	8 1/2	9	9 1/2
0	835	925	1 015	1 105	1 195	1 285	1 375	1 465	1 555	1 645
10	2 635	2 725	2 815	2 905	2 995	3 085	3 175	3 265	3 355	3 445
20	4 435	4 525	4 615	4 705	4 795	4 885	4 975	5 065	5 155	5 245
30	6 235	6 325	6 415	6 505	6 595	6 685	6 775	6 865	6 955	7 045
40	8 035	8 125	8 215	8 305	8 395	8 485	8 575	8 665	8 755	8 845
50	9 835	9 925	10 015	10 105	10 195	10 285	10 375	10 465	10 555	10 645
60	11 635	11 725	11 815	11 905	11 995	12 085	12 175	12 265	12 355	12 445
70	13 435	13 525	13 615	13 705	13 795	13 885	13 975	14 065	14 155	14 245
80	15 235	15 325	15 415	15 505	15 595	15 685	15 775	15 865	15 955	16 045
90	17 035	17 125	17 215	17 305	17 395	17 485	17 575	17 665	17 755	17 845
100	18 835	18 925	19 015	19 105	19 195	19 285	19 375	19 465	19 555	19 645

The structural widths below are calculated with 1-1 cm gap between the side plate of the verge tiles and the verge board.

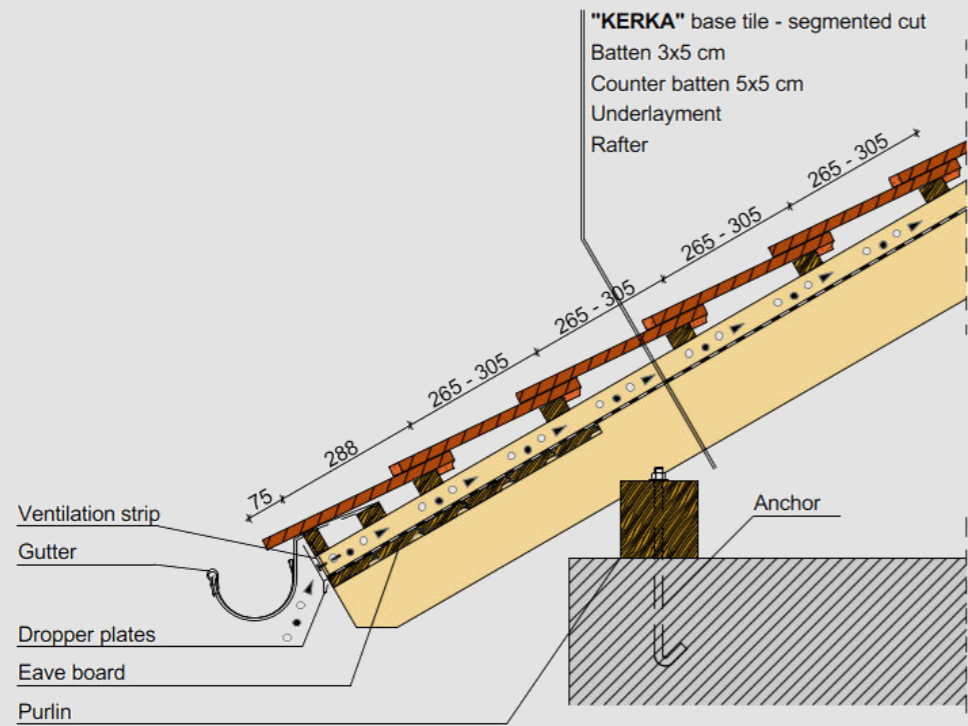

Eave detail

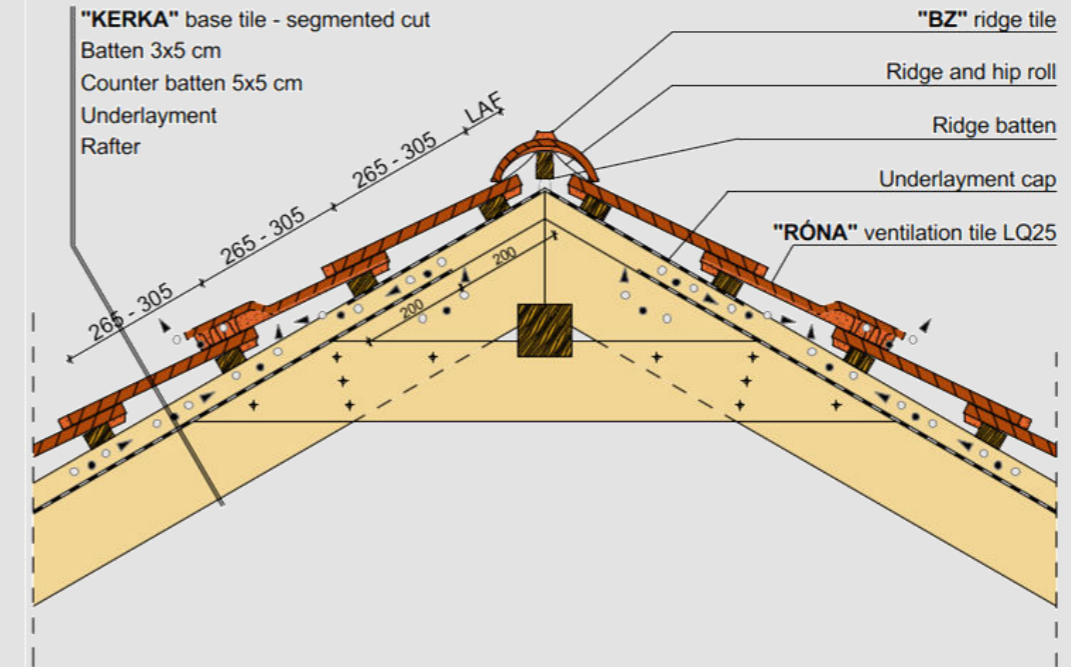

Ridge detail with ventilation tile

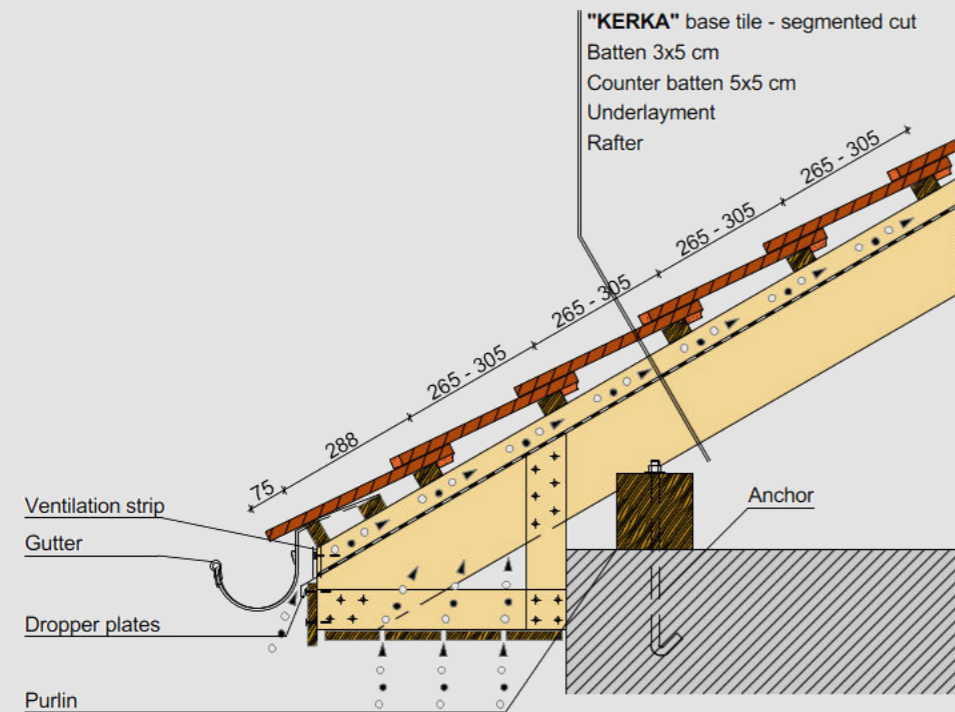

Closed eave detail

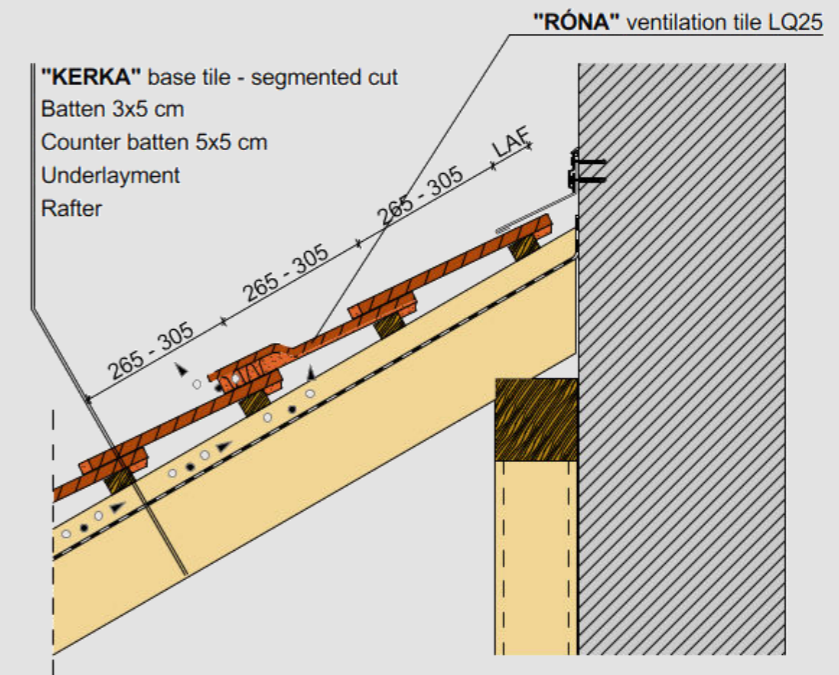

Wall connection detail

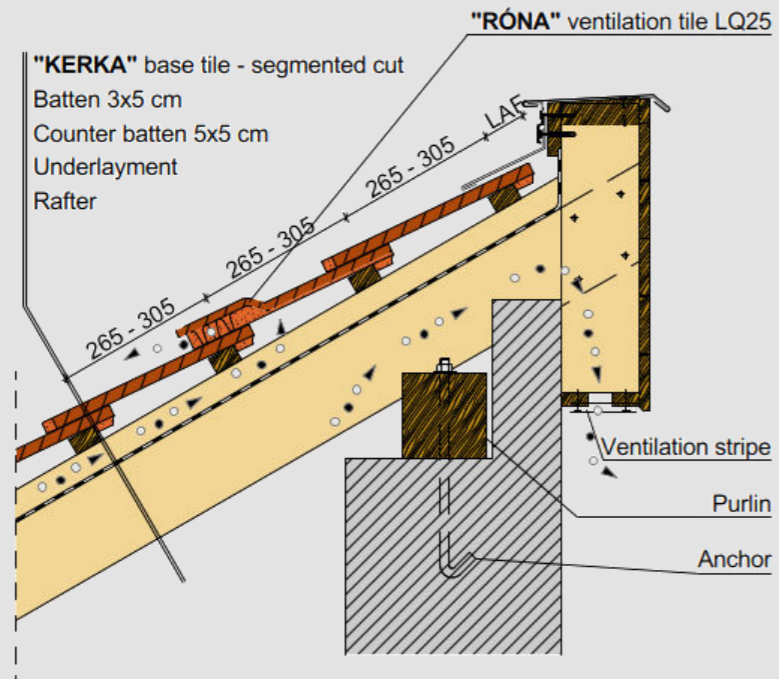

Shed roof ridge detail

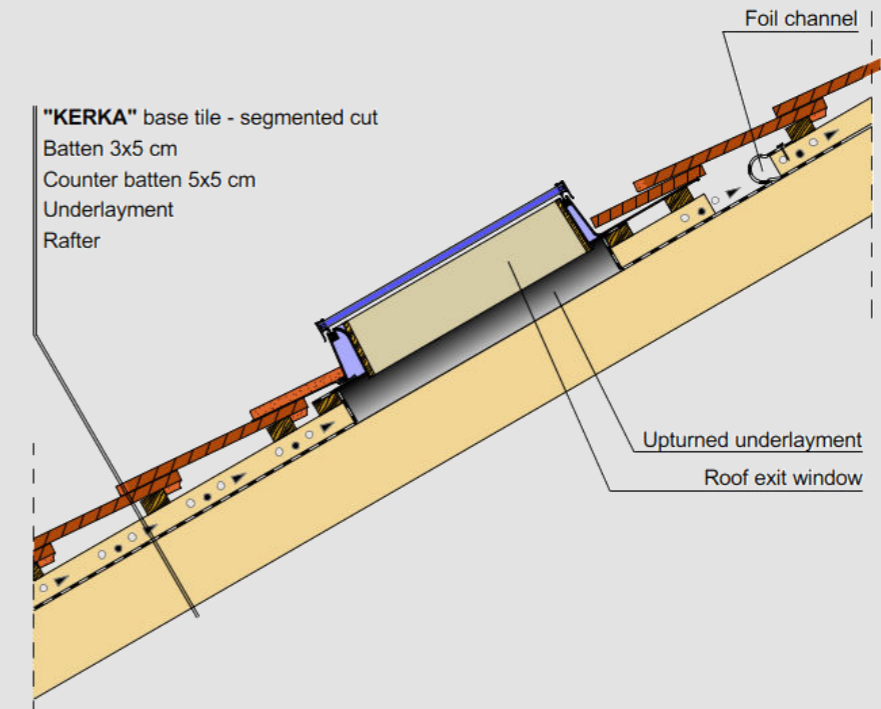

Roof exit window placement

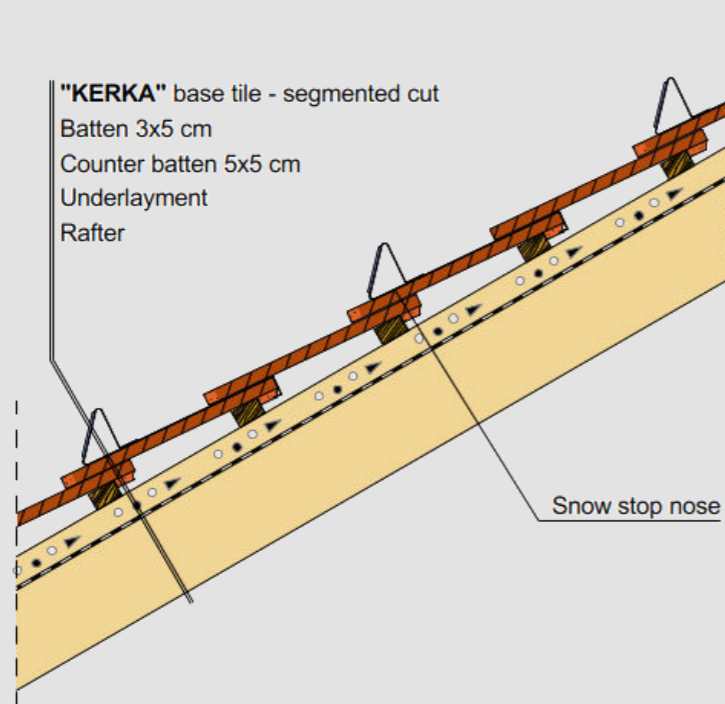

Snow stop nose placement

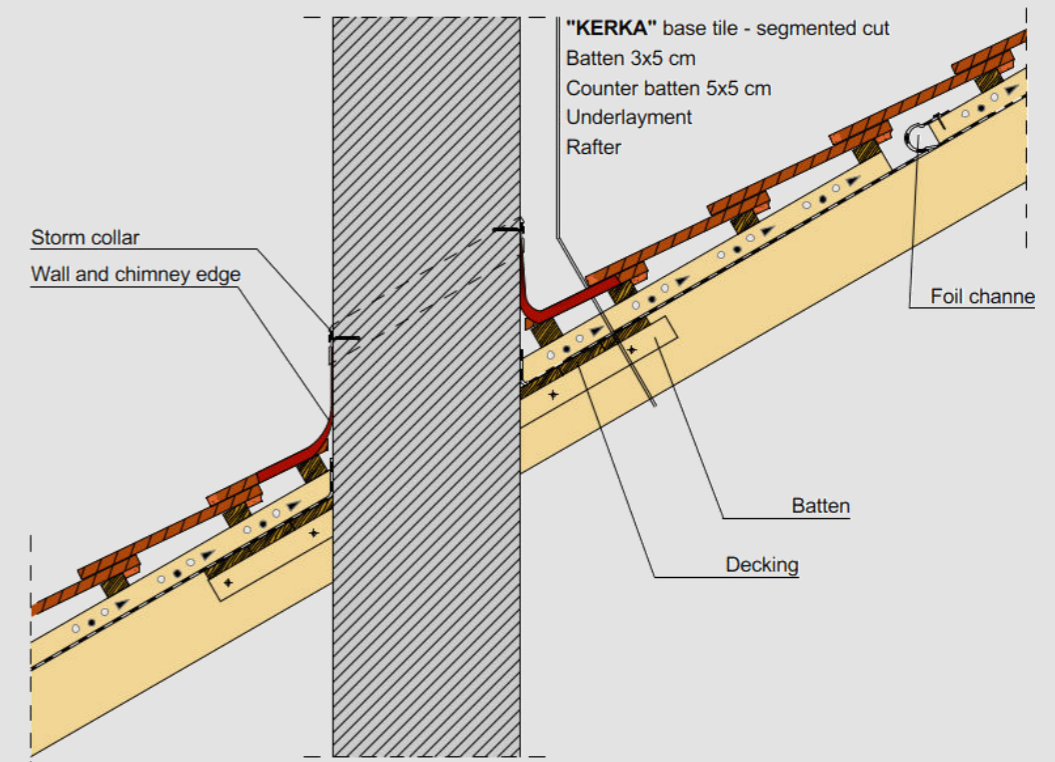

Chimney connection detail

“KERKA”® straight cut

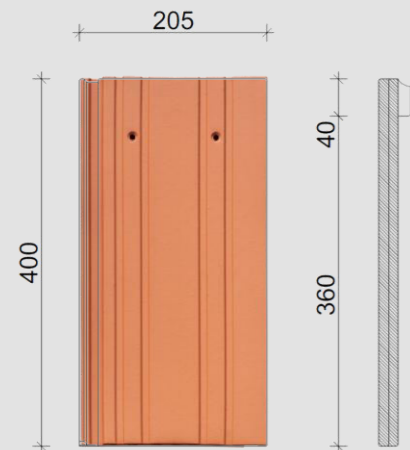

Product datas		Covering method
Size	width:	205 mm
	length:	400 mm
	height:	35 mm
	thickness:	21 mm
Packaging	Weight:	2,47 kg
	bundle:	6 pcs
	pallet:	324 pcs
Standard roof pitch :		30°
		In binding

Technical specification of the roof cover					
Roof pitch:	< 30°	30° - 35°	35° - 40°	40° - 45°	45° <
Covering length	280 mm	290 mm	300 mm	310 mm	320 mm
Covering width	180 mm	180 mm	180 mm	180 mm	180 mm
Consumption	19,8 pcs/m ²	19,2 pcs/m ²	18,5 pcs/m ²	17,9 pcs/m ²	17,4 pcs/m ²
Covering type	single cover				
Covering weight	51,87 kg/m ²	49,90 kg/m ²	48,17 kg/m ²	46,44 kg/m ²	44,96 kg/m ²

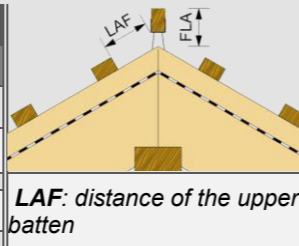

LAF: distance of the upper batten
FLA: height of the ridge batten

BZ ridge tile with 30x50 roof batten											
Roof pitch	10°	15°	20°	25°	30°	35°	40°	45°	50°	55°	60°
LAF [mm]	55	55	55	55	55	55	50	50	50	50	50

Underlayment requirement		
Unsupported underlayment	“UNO”	≥ 24°
Windproof underlayment	“DUO”	≥ 22°
Watertight underlayment	“TRIO”	≥ 18°
Waterproof underlayment	“QUATTRO”	≥ 10°

Required batten dimensions	
Rafter distance	Batten dimension
≤ 800 mm	30 x 50 mm
810 – 900 mm	30 x 50 mm
910 – 1000 mm	40 x 60 mm

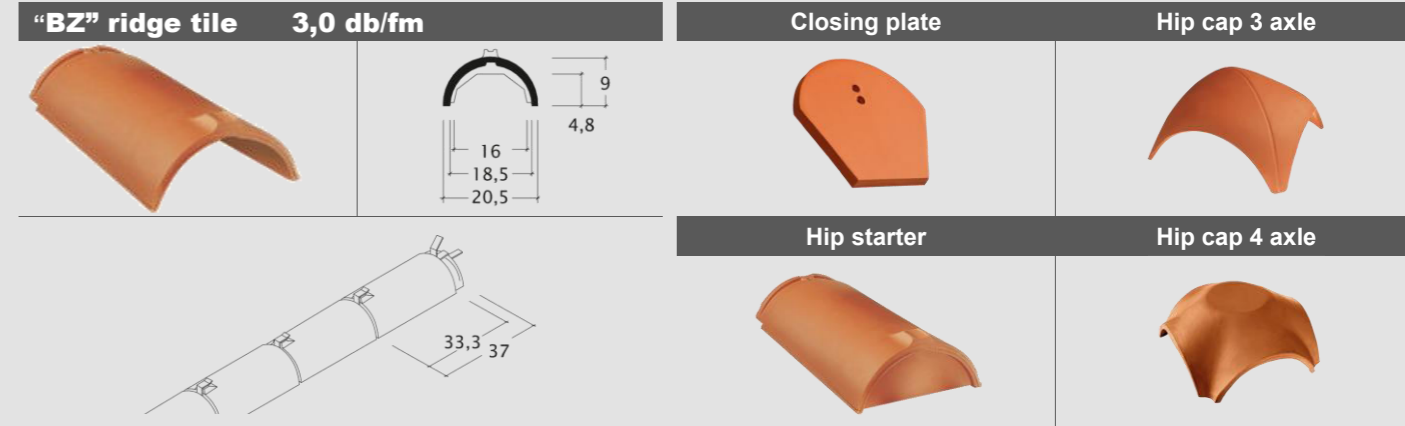

Clay accessories	Size	Quantity
Half tile	115x400	as needed
RÓNA Ventilation tile LQ 25	205x400	as required

Fixing products		
Name	Material	Application field
Mount-on stormclip for 30x50 mm battens	zinc-aluminium	Fixing against the wind in the edge zones and some cases in the general roof surface
Mount-on stormclip for 40x60 mm battens	zinc-aluminium	
Nail-in stormclip	stainless steel, CELANEX® PBT	Leesés elleni rögzítés szegélyek mentén és bizonyos esetekben általános tetőfelületeken.
Fixing screw with EPDM sealing ring, 60 mm length	stainless steel	
Clip with wire, 17-21 mm	stainless steel	Fixing against loosed tiles along the edges and some cases in the average roof surfaces
Universal screw-in stormclip	zinc-aluminium	Fixing cutted tiles along the hips and valleys

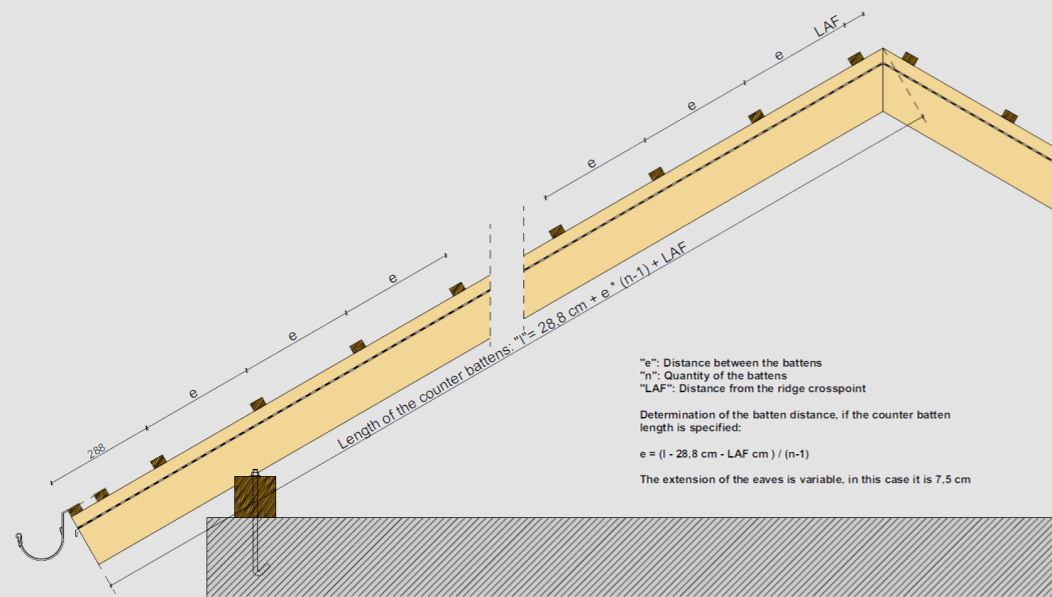

Roof batten alignment for "KERKA" straight cut clay roof tile

Specification: 7,5 cm eave overhang and 30° roof pitch
"BZ" ridge tile and 30x50 mm roof battens, LAF = 55 mm

Number of battens (n)	280 mm	290 mm	300 mm	310 mm	320 mm
10	2 863	2 953	3 043	3 133	3 223
11	3 143	3 243	3 343	3 443	3 543
12	3 423	3 533	3 643	3 753	3 863
13	3 703	3 823	3 943	4 063	4 183
14	3 983	4 113	4 243	4 373	4 503
15	4 263	4 403	4 543	4 683	4 823
16	4 543	4 693	4 843	4 993	5 143
17	4 823	4 983	5 143	5 303	5 463
18	5 103	5 273	5 443	5 613	5 783
19	5 383	5 563	5 743	5 923	6 103
20	5 663	5 853	6 043	6 233	6 423
21	5 943	6 143	6 343	6 543	6 743
22	6 223	6 433	6 643	6 853	7 063
23	6 503	6 723	6 943	7 163	7 383
24	6 783	7 013	7 243	7 473	7 703
25	7 063	7 303	7 543	7 783	8 023
26	7 343	7 593	7 843	8 093	8 343
27	7 623	7 883	8 143	8 403	8 663
28	7 903	8 173	8 443	8 713	8 983
29	8 183	8 463	8 743	9 023	9 303
30	8 463	8 753	9 043	9 333	9 623
31	8 743	9 043	9 343	9 643	9 943
32	9 023	9 333	9 643	9 953	10 263
33	9 303	9 623	9 943	10 263	10 583
34	9 583	9 913	10 243	10 573	10 903
35	9 863	10 203	10 543	10 883	11 223
36	10 143	10 493	10 843	11 193	11 543
37	10 423	10 783	11 143	11 503	11 863
38	10 703	11 073	11 443	11 813	12 183
39	10 983	11 363	11 743	12 123	12 503
40	11 263	11 653	12 043	12 433	12 823

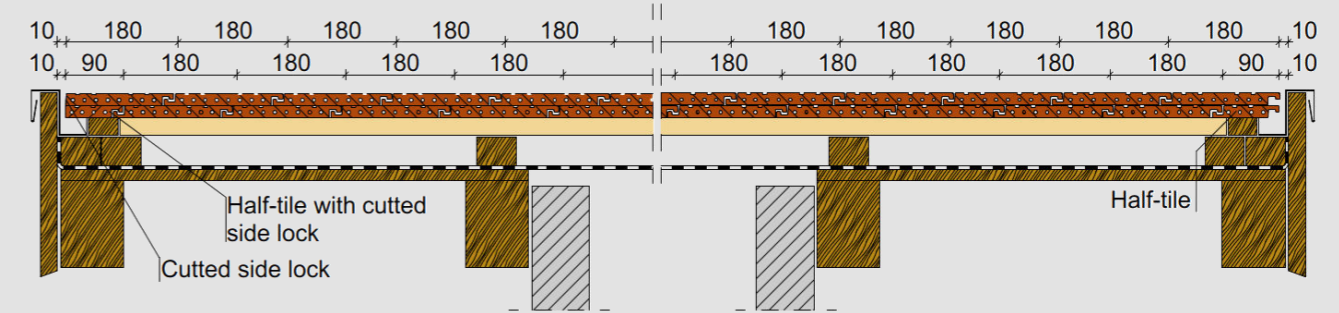

Structural width between the verge boards

	0	1/2	1	1 1/2	2	2 1/2	3	3 1/2	4	4 1/2
0	-	90	180	270	295	385	475	565	655	745
10	1 735	1 825	1 915	2 005	2 095	2 185	2 275	2 365	2 455	2 545
20	3 535	3 625	3 715	3 805	3 895	3 985	4 075	4 165	4 255	4 345
30	5 335	5 425	5 515	5 605	5 695	5 785	5 875	5 965	6 055	6 145
40	7 135	7 225	7 315	7 405	7 495	7 585	7 675	7 765	7 855	7 945
50	8 935	9 025	9 115	9 205	9 295	9 385	9 475	9 565	9 655	9 745
60	10 735	10 825	10 915	11 005	11 095	11 185	11 275	11 365	11 455	11 545
70	12 535	12 625	12 715	12 805	12 895	12 985	13 075	13 165	13 255	13 345
80	14 335	14 425	14 515	14 605	14 695	14 785	14 875	14 965	15 055	15 145
90	16 135	16 225	16 315	16 405	16 495	16 585	16 675	16 765	16 855	16 945
100	17 935	18 025	18 115	18 205	18 295	18 385	18 475	18 565	18 655	18 745

Structural width between the verge boards

	5	5 1/2	6	6 1/2	7	7 1/2	8	8 1/2	9	9 1/2
0	835	925	1 015	1 105	1 195	1 285	1 375	1 465	1 555	1 645
10	2 635	2 725	2 815	2 905	2 995	3 085	3 175	3 265	3 355	3 445
20	4 435	4 525	4 615	4 705	4 795	4 885	4 975	5 065	5 155	5 245
30	6 235	6 325	6 415	6 505	6 595	6 685	6 775	6 865	6 955	7 045
40	8 035	8 125	8 215	8 305	8 395	8 485	8 575	8 665	8 755	8 845
50	9 835	9 925	10 015	10 105	10 195	10 285	10 375	10 465	10 555	10 645
60	11 635	11 725	11 815	11 905	11 995	12 085	12 175	12 265	12 355	12 445
70	13 435	13 525	13 615	13 705	13 795	13 885	13 975	14 065	14 155	14 245
80	15 235	15 325	15 415	15 505	15 595	15 685	15 775	15 865	15 955	16 045
90	17 035	17 125	17 215	17 305	17 395	17 485	17 575	17 665	17 755	17 845
100	18 835	18 925	19 015	19 105	19 195	19 285	19 375	19 465	19 555	19 645

The structural widths below are calculated with 1-1 cm gap between the side plate of the verge tiles and the verge board.

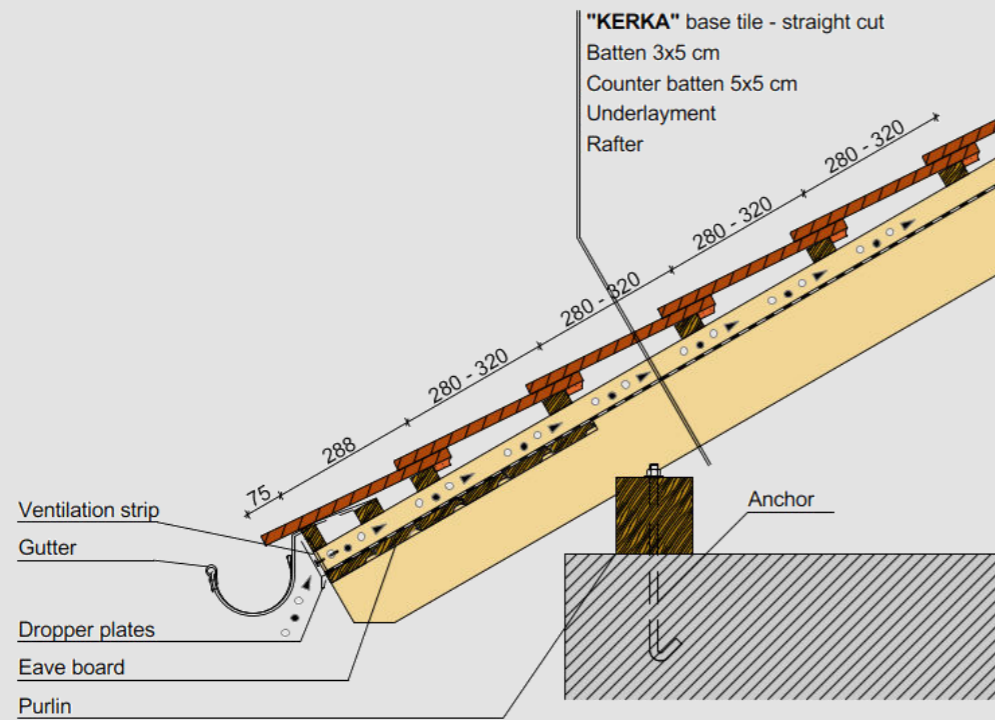

Eave detail

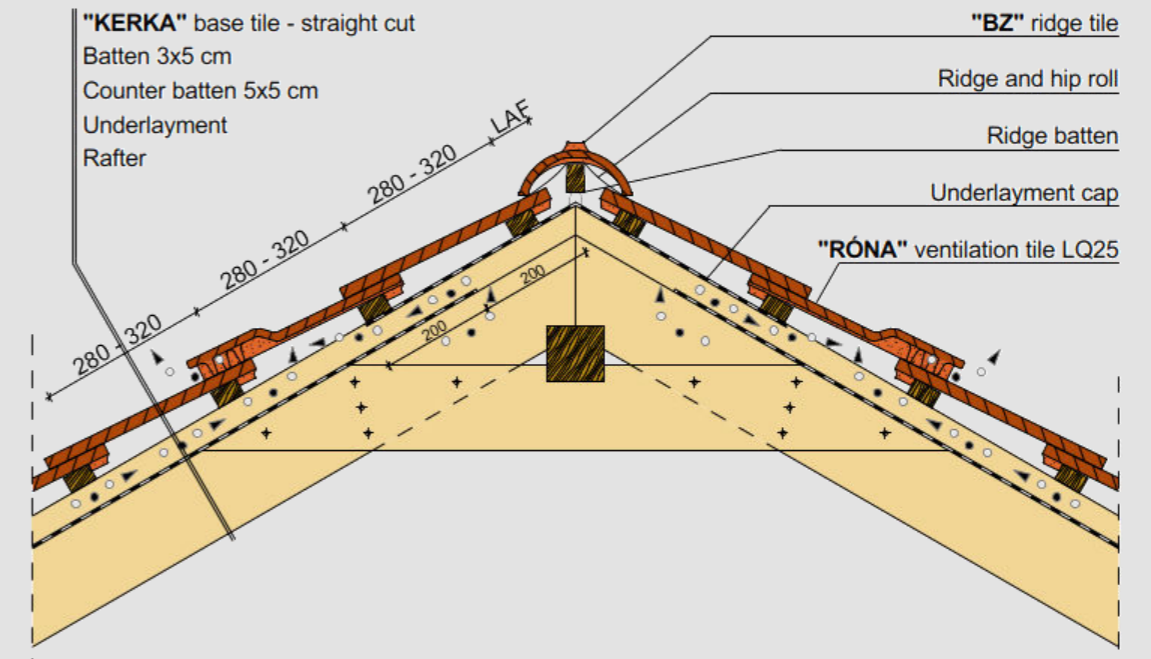

Ridge detail with ventilation tile

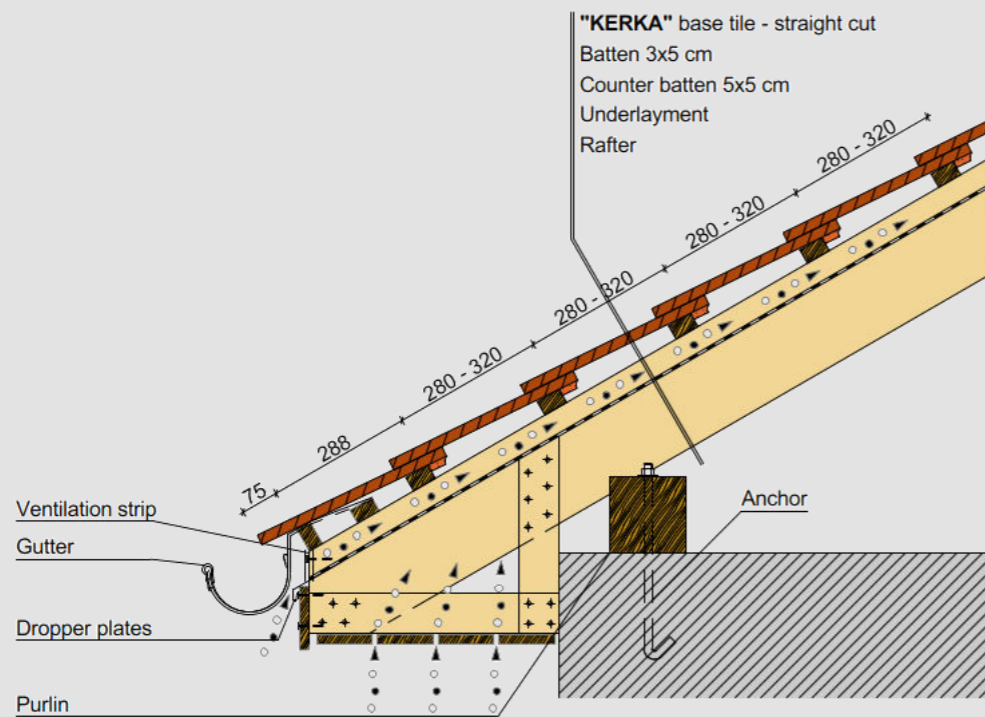

Closed eave detail

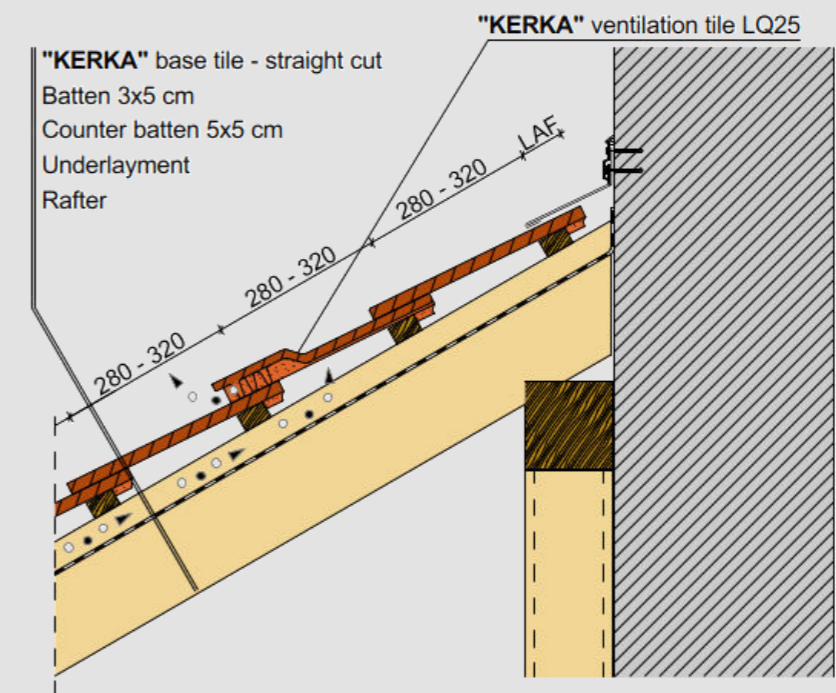

Wall connection detail

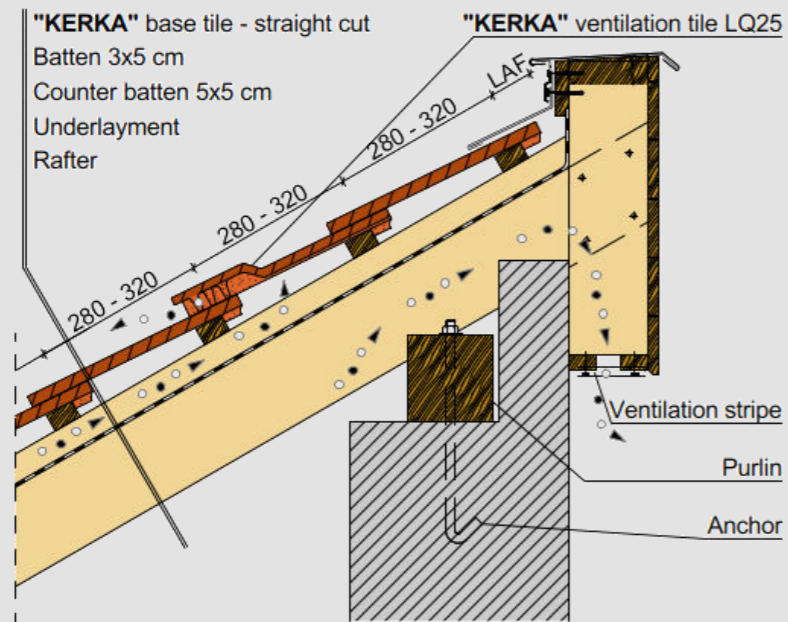

Shed roof ridge detail

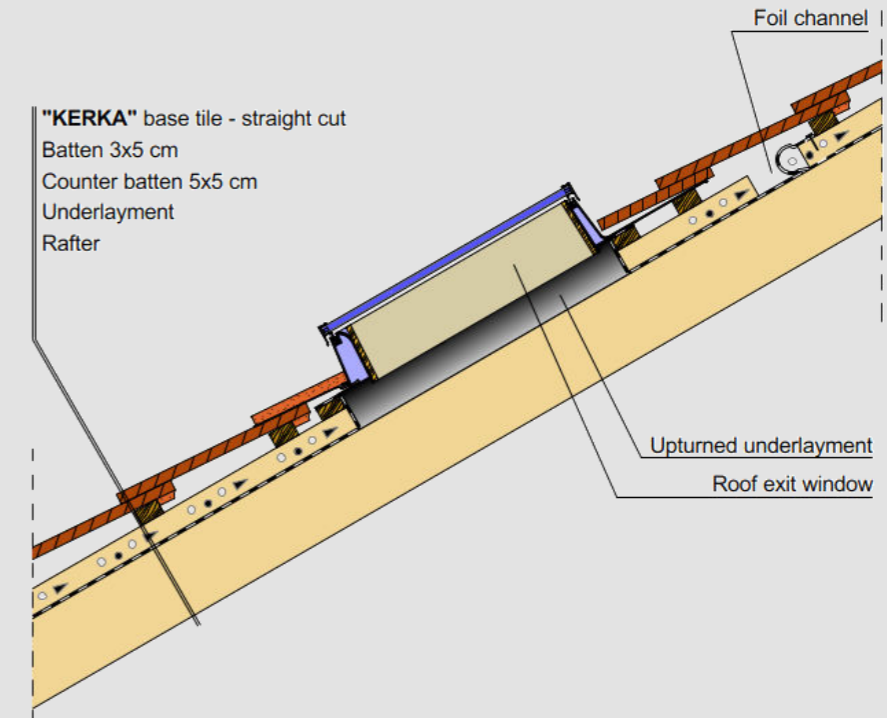

Roof exit window placement

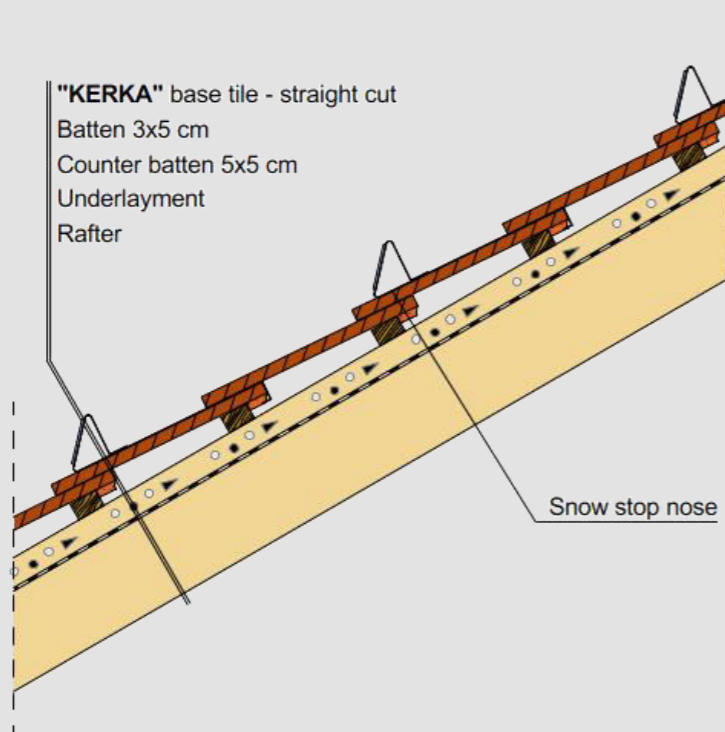

Snow stop nose placement

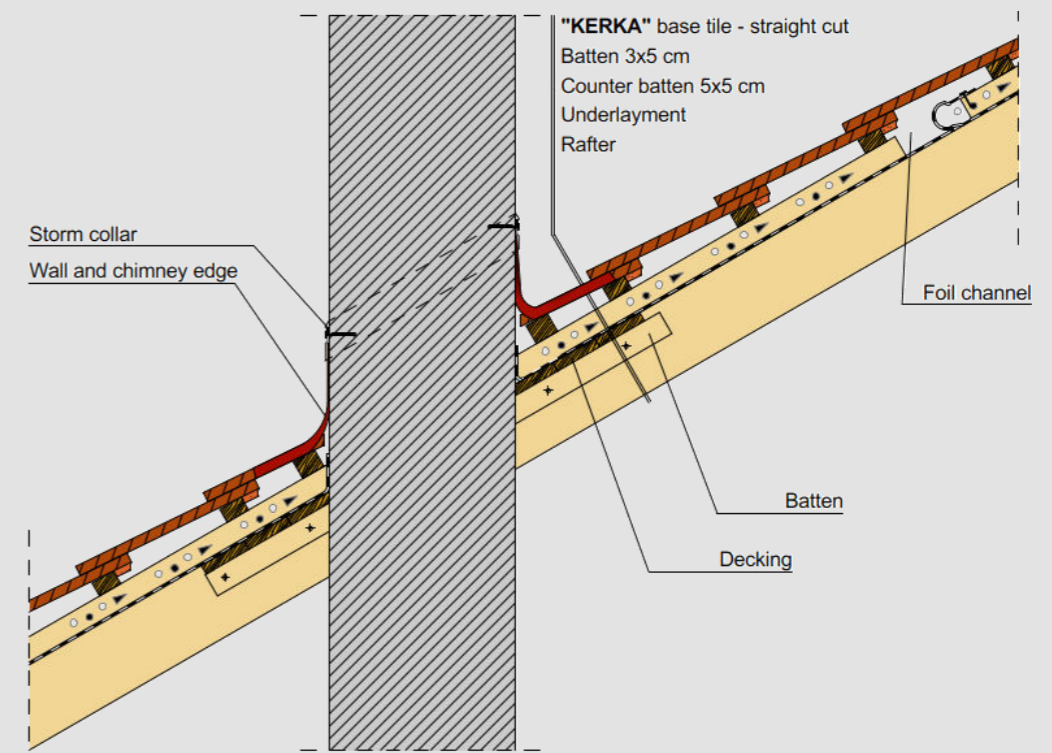

Chimney connection detail



CREATON South-East Europe Kft.

8960 Lenti, Cserépgyár u. 1.

Tel: +36 92 551 550

Fax: +36 92 551 559

e-mail: info@creaton.hu

www.creaton.hu